

AFTERCARE INSTRUCTIONS

This product should be treated with care. Excessive exposure to water will deteriorate the furniture.

All bathrooms should be well ventilated, if necessary, with a suitable extractor fan.

Avoid harsh chemical cleaners. Mild soap and water should be used with a soft cloth.

Wipe down wet surfaces after use.

CUSTOMER SERVICE

t: +44(0)208 686 5100
e: technical@saneux.com

4 Imperial Way
Croydon CR0 4RR

www.saneux.com

VOLATO

INSTALLATION INSTRUCTIONS

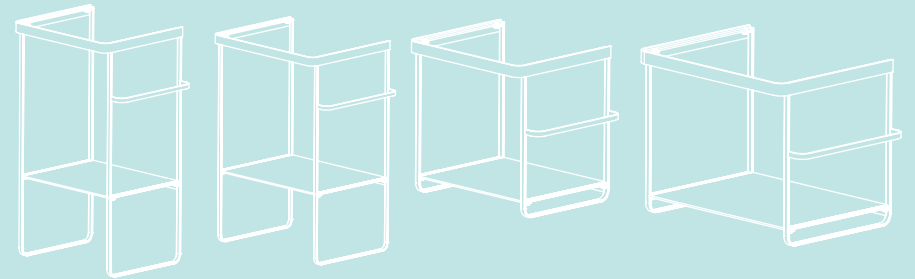



VOLO50F.MB, VOLO50W.MB, VOLO60F.MB,
VOLO60W.MB

saneux

Take care when drilling tiled surfaces as the drill might slip, and be sure to wear suitable eye protection when drilling. Beware of hidden pipes or cables. The basin and unit must be secured to a suitably strong wall to ensure stability. If in any doubt please consult an expert.

Ensure all components are present prior to installation.

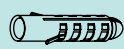
Washstand Fixings

-  x4 Steel wall fixings
-  x4 Wall Plugs
-  x8 Matte black M6 Bolts
-  x8 Matte black M6 Nut

COMPONENTS

Before beginning installation of the Washstand it is important to note that the frames are NOT load bearing, Therefore the basin will need to be wall mounted individually from the frame.

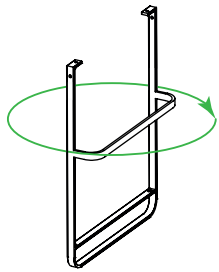

Decide whether you want the towel rail on the left or right hand side.

Then using 4 of the matte black fixings provided, assemble the side frames to the top frame.

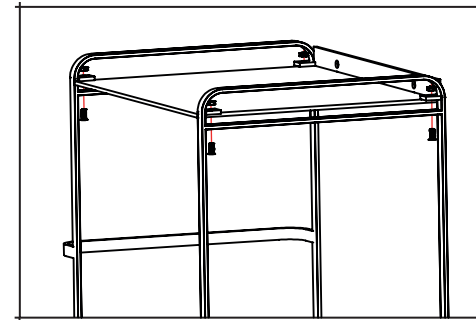
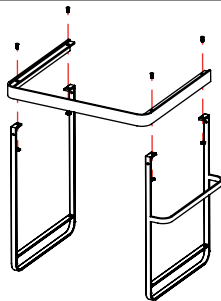

Turn the frame upside down, place on a soft, flat surface. Then using the remaining 4 matte black fixings assemble the shelf to the frame.

Measure the locations of the holes and the frame, and translate onto the wall. When mounted the top of the frame should be 850mm from the floor.

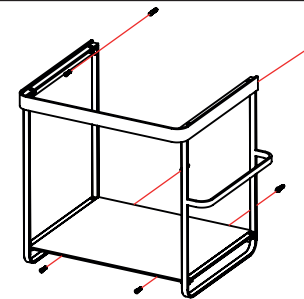
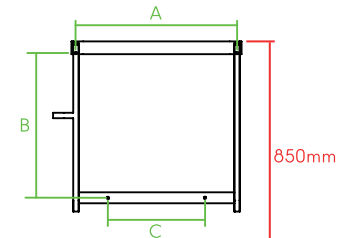

Drill the 4 holes, then insert wall plugs provided. Proceed to secure the frame to the wall using remaining screws provided.

Briefly place the basin onto the washstand frame and mark the fixing locations onto the wall. Then proceed to install the basin.

